

FLANGED DOC M SHOWER PACK – EXPOSED

(Click on product code or page number to view Datasheet)

| | |
|--|-------------------------|
| BC5083-SHE | Page 2 |
| BC5083-SHE Pack contains: | |
| BC5083-11 Shower Curtain Rail x1 | Page 3 |
| BC5083-12 Shower Rail Ceiling Stay x1 | Page 4 |
| BC5083-14 Shower Curtains x2 | Page 5 |
| BC3083-13 Shower Curtain Hooks x24 | Page 6 |
| BC5083-02 Grab Rail – 600mm x3 | Page 7 |
| BC5083-01 Grab Rail – 450mm x1 | Page 8 |
| BC5084-06 Hinged Drop Down Rail x2 | Page 9 |
| BC5083-37 Back Rest x1 | Page 10 |
| BC5083-10 Shower Seat x1 | Page 11 |
| BC5083-121 Alarm Pull Cord x1 | Page 12 |
| BC725 Robe Hooks x2 | Page 13 |
| BC5083-101 Mirror 1000mm x 400mm x1 | Page 14 |
| BC5083-15 Exposed Shower Valve x1 | Page 15 |
| BC5083-16 Exposed Two-Way Diverter x1 | Page 16 |
| BC5083-24 Shower Riser Kit – Hand Held and Hose x1 | Page 17 |
| DB1032 Shower Head x1 | Page 18 |
| Shower Riser Rail and Bracket x1 | Page 19 |
| BC5083-18 Copper Tube x1 | Page 20 |



BC5083-SHE

DOLPHIN FLANGED DOC M SHOWER SET – EXPOSED

- › Compliant with Part M of the Building Regulations
- › Complete set includes all of the items listed below to ensure compliance from specification to installation
- › All items of a co-ordinated design to achieve a consistent aesthetic look throughout the washroom
- › Cost effective alternative to sourcing all items individually
- › Set is delivered in one package for easy installation to assist blind or partially sighted persons in navigating the washroom there should be a contrast difference of 30 between the LRV (Light Reflective Value) of fixtures/fittings and surrounding surfaces as well as between floors, walls, doors and ceilings. Contact the Dolphin Technical Team for assistance.
- › This pack uses TMV3 Certified valves
- › BC5083-SHE Pack contains:
 - › BC5083-11 Shower Curtain Rail x1
 - › BC5083-12 Shower Rail Ceiling Stay x1
 - › BC5083-14 Shower Curtains x2
 - › BC3083-13 Shower Curtain Hooks x24
 - › BC5083-02 Grab Rail – 600mm x3
 - › BC5083-01 Grab Rail – 450mm x1
 - › BC5083-06 Hinged Drop Down Rail x2
 - › BC5083-37 Back Rest x1
 - › BC5083-10 Shower Seat x1
 - › BC5083-121 Alarm Pull Cord x1
 - › BC725 Robe Hooks x2
 - › BC5083-101 Mirror 1000mm x 400mm x1
 - › BC5083-15 Exposed Shower Valve x1
 - › BC5083-16 Exposed Two-Way Diverter x1
 - › BC5083-24 Shower Riser Kit – Hand Held and Hose x1
 - › DB1032 Shower Head x1
 - › BC5083-04PSS / BC5083-25 Shower Riser Rail and Bracket x1
 - › BC5083-18 Copper Tube x1
 - › WRAS certification numbers
 - › BC5083-15 : 1603305
 - › BC5083-16 : 1509318
 - › Flow Rates
 - › DB1032 : 9 litres per minute flow regulator supplied, other flow rates available on special request
 - › BC5083-15 : 6 Litres per minute and 9 Litres per minute flow regulators both supplied, other flow rates available on special request



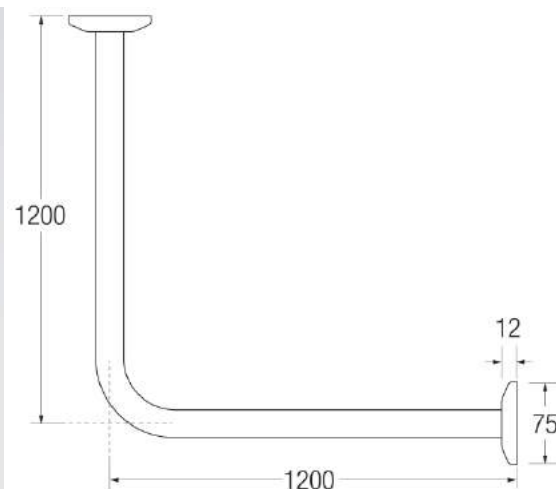

BC5083-11 / BC5083-11-PSS

DOLPHIN 1200MM X 1200MM SHOWER CURTAIN RAIL

- › Non-corrosive stainless steel construction
- › Concealed fixings
- › Bespoke lengths, shapes and sizes available
- › Doc M compliant
- › Ceiling stay (not included) available for purchase separately, code BC5083-12
- › For use with BC5083-13 curtain hooks and BC5083-14 shower curtain (not included)
- › Available in satin brushed and mirror polish finishes
- › Powder coated finishes in any RAL colour also available

| | |
|---------------------|--------|
| PROJECTION | 1200MM |
| DIAMETER | 25MM |
| HEIGHT FROM CEILING | 500MM |

PRODUCT CODES

BC5083-11 - Stainless Steel Shower Curtain Rail 1200mm x 1200mm Satin Brushed Finish

BC5083-11-PSS - Stainless Steel Shower Curtain Rail 1200mm x 1200mm Mirror Polish Finish

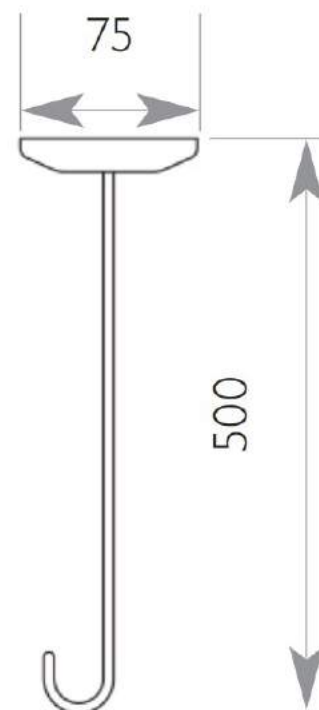

BC5083-12

DOLPHIN SHOWER RAIL CEILING STAY

- › High quality satin stainless steel construction
- › Use with BC5083-13 curtain hooks, BC5083-14 shower curtain, and BC5083-11 curtain rail (all supplied separately)

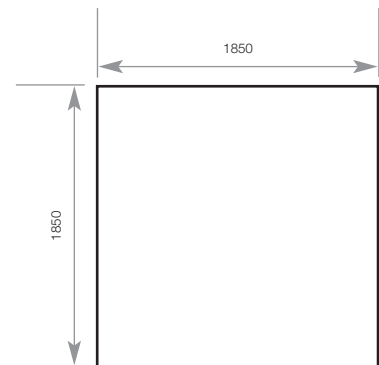

BC5083-14

DOLPHIN SHOWER CURTAIN

- › White shower curtain
- › 4oz weighted white polyester
- › Hooks are not included with curtain
- › 12 hooks required per curtain

| | |
|--------|---------|
| HEIGHT | 1830 MM |
| WIDTH | 1830 MM |



BC5083-13

DOLPHIN CURTAIN HOOKS BRASS CHROME PLATED

› Use with BC5083-11 Dolphin corner shower rail

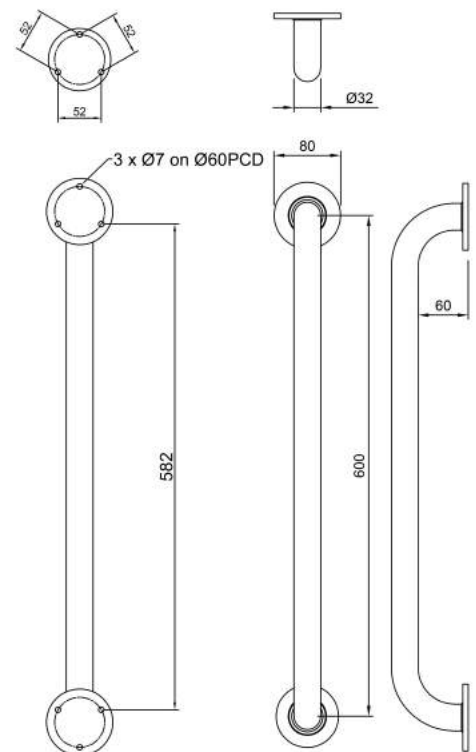

BC5083-02

DOLPHIN STAINLESS STEEL GRAB RAIL

- > High quality satin stainless steel
- > 32mm diameter
- > Concealed fixings
- > The BC5083-02 grab rail has been tested for a load bearing capacity in excess of 200kg in accordance with BS EN 12182:2012 section 16.2

| | |
|-------------------|-------|
| LENGTH | 600MM |
| PROJECTION | 92MM |
| INSIDE PROJECTION | 60MM |
| DIAMETER | 32MM |

PRODUCT CODES

- BC5083-01** - Dolphin 450mm grab rail
- BC5083-02** - Dolphin 600mm grab rail
- BC5083-04** - Dolphin 900mm grab rail

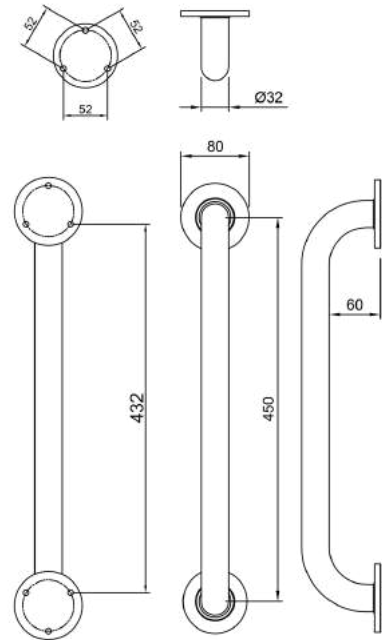

BC5083-01

DOLPHIN 450MM STAINLESS STEEL GRAB RAIL

- > High quality satin stainless steel
- > 32mm diameter
- > Concealed fixings
- > The BC5083-01 grab rail has been tested for a load bearing capacity in excess of 200kg* in accordance with BS EN 12182:2012 section 16.2

| | |
|-------------------|-------|
| LENGTH | 450MM |
| PROJECTION | 92MM |
| INSIDE PROJECTION | 60MM |
| DIAMETER | 32MM |

PRODUCT CODES

- BC5083-01** - Dolphin 450mm grab rail
- BC5083-02** - Dolphin 600mm grab rail
- BC5083-04** - Dolphin 900mm grab rail

*When fixed to a suitable surface

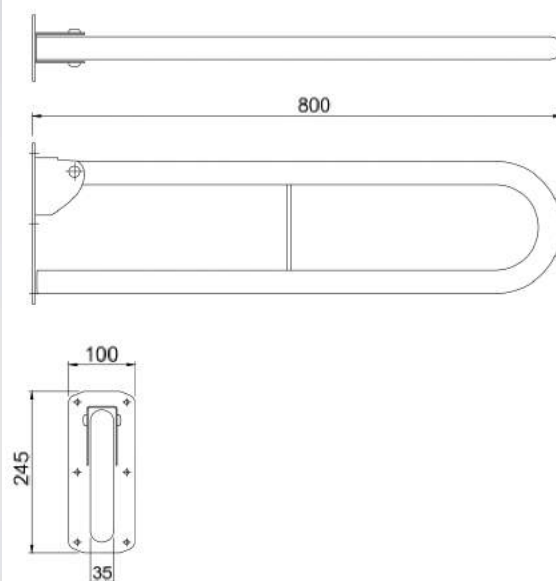

BC5084-06

DOLPHIN STAINLESS STEEL HINGED RAIL

- › Non-corrosive stainless steel construction
- › Soft fall friction mechanism
- › Bespoke lengths, shapes and sizes available
- › Doc M compliant
- › All rails capable of supporting 170kg
- › Also available in a 650mm length (BC5084-06650)

| | |
|----------------------|--------------|
| HEIGHT | 245MM |
| DIAMETER | 35MM |
| PROJECTION | 800MM |
| FIXINGS HOLES | 8MM |

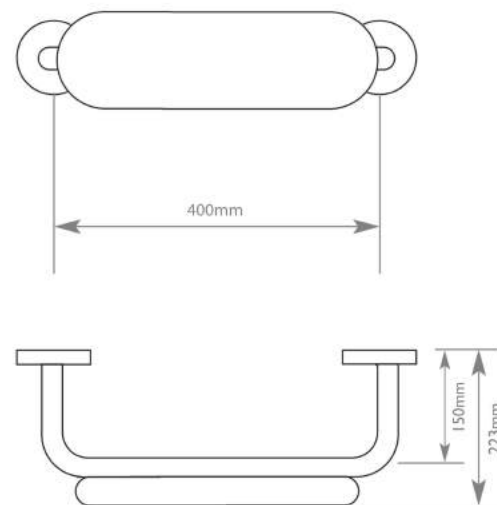

BC5083-37

DOLPHIN STAINLESS STEEL PADDED BACKREST

- › High quality satin stainless steel and vinyl cushion
- › Concealed fixings
- › Hard wearing and easy to clean vinyl cushion can be supplied in both blue and white vinyl
- › Works well with the BC5083-10 Fold down shower seat
- › Available to be powder coated in any RAL colour (please contact the team for further details)

| | |
|-------------------|--------------|
| PROJECTION | 223MM |
| WIDTH | 400MM |

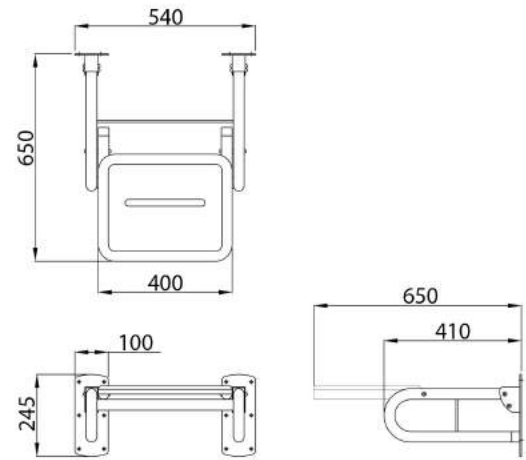

BC5083-10

DOLPHIN DOC M SHOWER SEAT

- › Can be paired with 150mm projection back rest rail and back rest pads to create a back rest for extra comfort.
- › Seat can be flipped up when not in use
- › Available with black or white seats
- › Available in satin or mirror polish finish
- › Doc M compliant
- › Capable of supporting 150kg

| | |
|-------------------|--------------|
| WIDTH | 540MM |
| HEIGHT | 250MM |
| PROJECTION | 650MM |

PRODUCT CODES

BC5083-10 - Stainless Steel Doc M Shower Seat With White Seat 650mm Satin Finish

BC5083-10-PSS - Stainless Steel Doc M Shower Seat With White Seat 650mm Mirror Polish Finish

BC5083-10BL - Stainless Steel Doc M Shower Seat With Black Seat 650mm Satin Finish

BC5083-10BL-PSS - Stainless Steel Doc M Shower Seat With Black Seat 650mm Mirror Polish Finish



BC5083-121

STAINLESS STEEL DISABLED ALARM SYSTEM WITH PULL CORD

- › Essential for every public accessible washroom
- › Included in all Dolphin Doc M shower and WC room sets
- › Available in white plastic or satin stainless steel
- › Doc M compliant

PRODUCT CODES

BC5083-120 - White Plastic Disabled Alarm System With Pull Cord

BC5083-121 - Stainless Steel Disabled Alarm System With Pull Cord

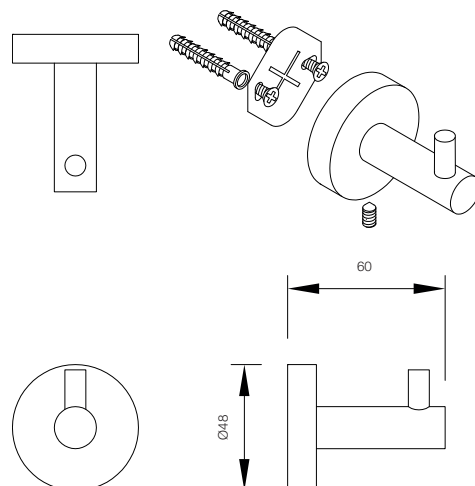
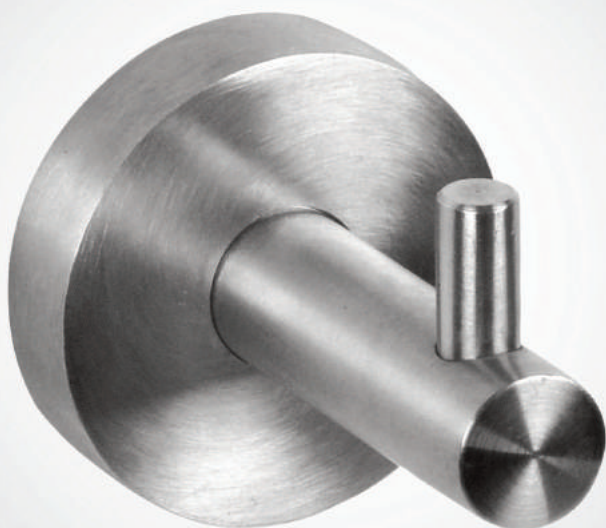

BC725

DOLPHIN SINGLE ROBE HOOK

- › Timeless design for prestigious appearance in high class environments
- › 304 stainless steel for easy care and durability
- › Robust 'hidden fix' anti-rotation wall plate fixing for secure anti-theft mounting
- › Available in satin (brushed) stainless steel to compliment other Dolphin products

| | |
|-------------------|--------------|
| DIAMETER | 48 MM |
| PROJECTION | 60 MM |

PRODUCT CODES

- › Double hook see

BC726

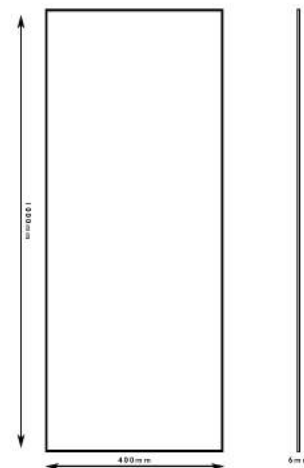
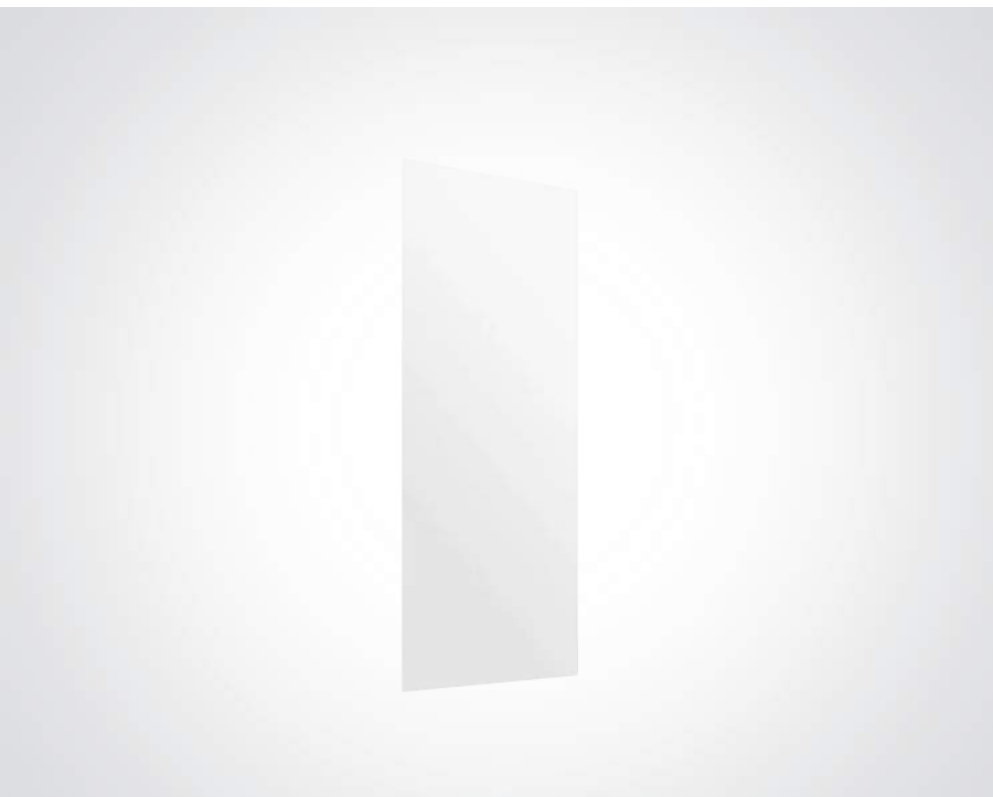

BC5083-101

DOLPHIN SAFETY BACKED MIRROR

- > Safety backed glass mirror
- > Suitable for accessible washrooms and shower rooms
- > 1000mm x 400mm x 6mm
- > Frameless
- > Bespoke options available

| | |
|------------------|---------------|
| HEIGHT | 1000MM |
| WIDTH | 400MM |
| THICKNESS | 6MM |

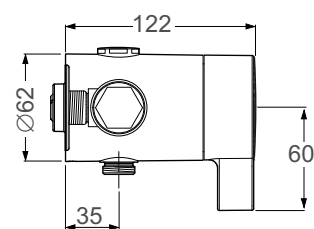
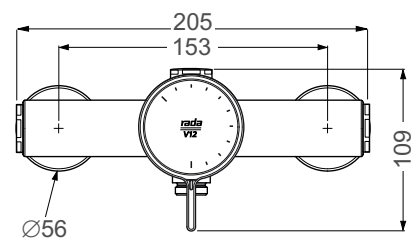

BC5083-15

THERMOSTATIC SHOWER VALVE

- › Buildcert TMV3 Scheme Approved
- › WRAS Approved
- › Single sequential operation from off through cold to warm
- › Light touch control complemented by easy to understand graphics to address the needs of all users irrespective of age or ability
- › Robust construction to withstand heavy usage in the commercial environment
- › Optional 6 l/min flow regulator for increased water savings. A 9 l/min flow regulator is also supplied
- › Easy access to filters for servicing.

| | |
|-------------------|---------------|
| WIDTH | 205 MM |
| HEIGHT | 109 MM |
| PROJECTION | 122 MM |



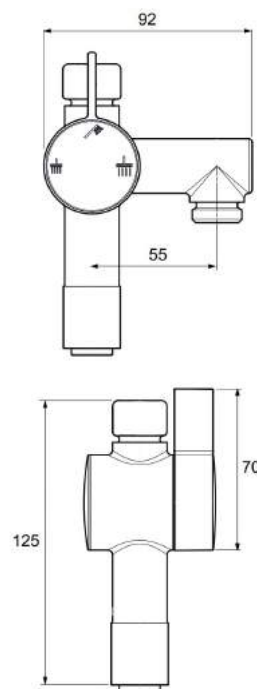

BC5083-16

DOLPHIN EXPOSED SHOWER DIVERTER VALVE

- › Two outlet diverter valve, designed to add extra convenience and flexibility to showering
- › Designed for use with the Rada VI2 Exposed shower valve
- › Simple to use - allows you to divert water between two different outlets off the same shower valve, or to have both running simultaneously
- › Suitable for either high or low pressure systems

PRODUCT CODES

BC5083-16 - Exposed shower diverter

BC5083-15 - Exposed shower valve

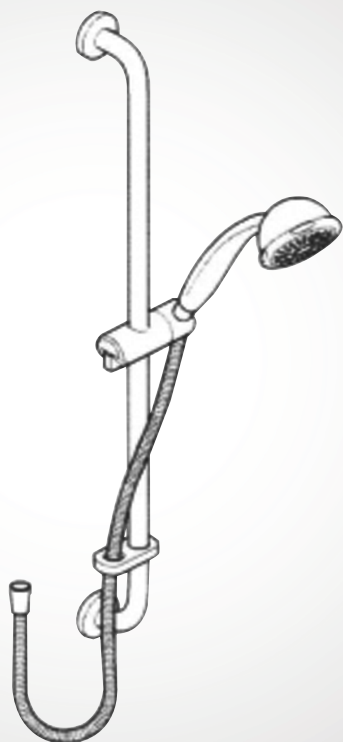

BC5083-24

DOLPHIN SHOWER HANDSET AND HOSE

- › An adjustable spray handset with 5 spray actions.
- › Supplied complete with flexible hose.
- › Doesn't include rail and shower head holder.

PRODUCT CODES

- › **BC5083-24** Dolphin Shower Handset and Hose

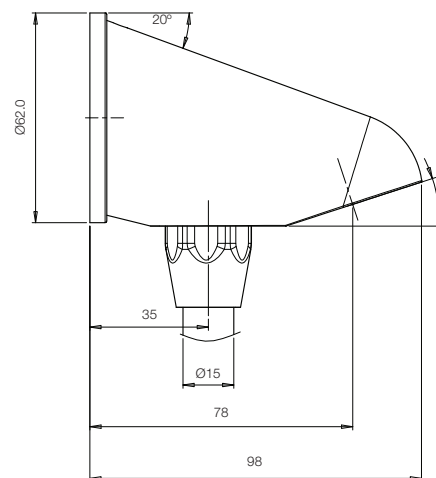

DB I032

DOLPHIN SHOWER HEAD WALL MOUNTED - BOTTOM INLET

- › WRAS Approved product
- › High quality chrome plated solid brass construction.
- › Vandal resistant
- › Standard ½" Bottom Inlet
- › 9 L/M flow restrictor offering excellent water saving especially when used in conjunction with Dolphin Blue Infrared and Piezo Shower Controls. Also available with 7 and 6 L/M flow restrictors
- › To special order:
- › 2 year warranty
- › Ideal for public shower facilities, including: prisons, sport facilities, swimming pools, hospitals and schools.
- › For rear inlet version of this product see DB I031
- › Easy clean nozzles - lime deposits can be rubbed off easily due to soft silicone nozzles.

| | |
|------------|-------|
| DIAMETER | 62 MM |
| PROJECTION | 98 MM |

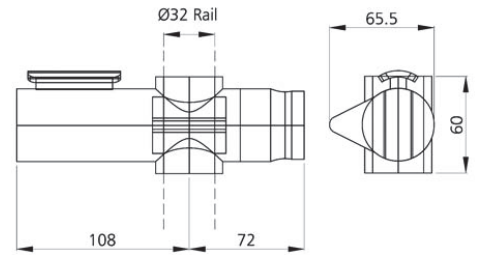

BC5083-25

DOLPHIN 32MM SLIDER BRACKET FOR SHOWER HEAD HOLDER

- › This shower bracket has been designed to provide users with an adjustable shower head height and to make it easier for users with limited dexterity.

| | |
|-------------------|----------------|
| WIDTH | 180 MM |
| HEIGHT | 60 MM |
| PROJECTION | 65.6 MM |

INSTALLATION

- › Installation should be carried out by a suitably qualified tradesman.
- 1. Once the shower slider/grab rail has been installed this bracket can be installed on it.
- 2. Take the infill part out of the back of the bracket.
- 3. Push the bracket onto the shower slider/grab rail until it clamps.
- 4. Put the infill back into the back of the bracket.
- 5. Push the grey clip through the bracket and the infill to lock the infill onto the back of the bracket.
- 6. Ensure the grey clip is pushed all the way through and then secure the grey clip on the opposite side with the screw provided
- 7. Always carry out a functional test after installation and report any issues immediately.
- 8. Please leave these instructions with the user.

PRODUCT CODES

- › **BC5083-25** 32mm Slider Bracket for Shower Head Holder



BC5083-18

COPPER TUBE FOR USE IN DOLPHIN SHOWER PACKS

- › Cu-DHP grade copper
- › Suitable for any plumbing, heating and gas installation
- › Meets BS EN1057
- › BSi Kitemark licensed
- › 15mm diameter, 0.7mm thick copper tubing
- › Offers easy manipulation due to half-hard condition
- › Able to withstand high internal pressures,
- › Suitable for use with hot and cold water
- › Supplied in a 1500mm length.

| | |
|----------------|--------|
| LENGTH | 1500MM |
| DIAMETER | 15MMMM |
| WALL THICKNESS | 0.7MM |