

# FLANGED DOC M SHOWER PACK – CONCEALED

(Click on product code or page number to view Datasheet)

<b>BC5083-SCC_A</b>	<a href="#">Page 2</a>
<b>BC5083-SCC_A Pack contains:</b>	
DB3100 ShowerValve x1	<a href="#">Page 3</a>
DB3001 Shower Head x1	<a href="#">Page 4</a>
DB3061.350 Shower Arm x1	<a href="#">Page 5</a>
DB3073 Shower Outlet x1	<a href="#">Page 6</a>
DB3041 Shower Hose x1	<a href="#">Page 7</a>
DB3020 Hand Held Shower Head x1	<a href="#">Page 8</a>
DB3090.450 Slider Rail and Holder x1	<a href="#">Page 9</a>
BC5083-11 Shower Curtain Rail x1	<a href="#">Page 10</a>
BC5083-12 Shower Rail Ceiling Stay x1	<a href="#">Page 11</a>
BC5083-14 Shower Curtains x2	<a href="#">Page 12</a>
BC5083-13 Shower Curtain Hooks x24	<a href="#">Page 13</a>
BC5083-02 Grab Rail – 600mm x3	<a href="#">Page 14</a>
BC5083-01 Grab Rail – 450mm x1	<a href="#">Page 15</a>
BC5084-06 Hinged Drop Down Rail x2	<a href="#">Page 16</a>
BC5083-37 Back Rest x1	<a href="#">Page 17</a>
BC5083-10 Shower Seat x1	<a href="#">Page 18</a>
BC5083-121 Alarm Pull Cord x1	<a href="#">Page 19</a>
BC725 Robe Hooks x2	<a href="#">Page 20</a>
BC5083-101 Mirror 1000mm x 400mm x1	<a href="#">Page 21</a>



**BC5083-SCC\_A**

## **DOLPHIN FLANGED DOC M SHOWER SET**

- › Compliant with Part M of the Building Regulations
- › Complete set includes all of the items listed below to ensure compliance from specification to installation
- › All items of a co-ordinated design to achieve a consistent aesthetic look throughout the washroom
- › Cost effective alternative to sourcing all items individually
- › Set is delivered in one package for easy installation
- › To assist blind or partially sighted persons in navigating the washroom there should be a contrast difference of 30 between the LRV (Light Reflective Value) of fixtures/fittings and surrounding surfaces as well as between floors, walls, doors and ceilings. Contact the Dolphin Technical Team for assistance.
- › This pack uses TMV Certified valves
- › BC5083-SCC\_A Pack contains:
  - › DB3100 Shower Valve x1
  - › DB3001 Shower Head x1
  - › DB3061.350 Shower Arm x1
  - › DB3070 Shower Outlet x1
  - › DB3041 Shower Hose x1
  - › DB3020 Hand Held Shower Head x1
  - › DB3090.450 Slider Rail and Holder x1
  - › BC5083-11 Shower Curtain Rail x1
  - › BC5083-12 Shower Rail Ceiling Stay x1
  - › BC5083-14 Shower Curtains x2
  - › BC5083-13 Shower Curtain Hooks x24
  - › BC5083-02 Grab Rail – 600mm x1
  - › BC5083-01 Grab Rail – 450mm x1
  - › BC5084-06 Hinged Drop Down Rail x 2
  - › BC5083-37 Back Rest x1
  - › BC5083-10 Shower Seat x1
  - › BC5083-121 Alarm Pull Cord x1
  - › BC725 Robe Hooks x2
  - › BC5083-101 Mirror 1000mm x 400mm x1
  - › WRAS certification numbers
    - › DB3100 : 1911347
    - › DB3001 : 2003342
    - › DB3060.200 : 2003371
    - › DB3070 : 2003357
    - › DB3041 : 1904081



NOTE: This pack is only compliant when installed in line with BS8300 and Doc M requirements.

TECHNICAL HELPLINE 01424 202224  
DOLPHINSOLUTIONS.CO.UK

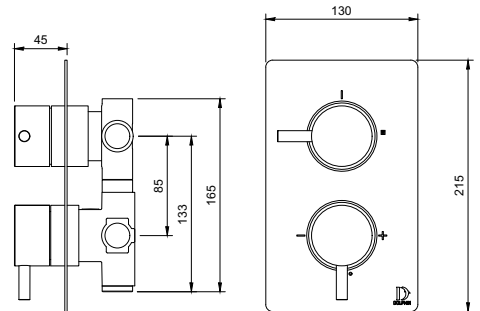

**DB3100.x(.xx) DB3101.x(.xx)**

## DOLPHIN BLUE SHOWER VALVE

- › Dolphin Blue Shower Valve with Thermostatic Temperature Control and Two-Ways Diverter
- › Minimalist design with slimline rectangular face plate
- › TMV2 thermostatic temperature control maintains consistent, comfortable showering temperature whilst ensuring against scalding
- › 30mm levers on the DB3100 version (As shown above) allow operation even with a clenched fist ideal for installation in accessible areas
- › Also available is the lever-less DB3101 version
- › Two outlets (two-ways diverter) for connection to an fixed shower head and hand held shower head with hose (sold separately)
- › Single outlet (headworks) also available for either fixed shower head OR hand held shower head with hose – see DB3200/DB3201
- › Complements most of our other Dolphin taps and fittings
- › Available in both Satin and Chrome finishes
- › High quality brass and stainless steel construction with highest quality cartridges and mechanisms from market leading specialist manufacturers from within Europe to ensure robust and reliable performance in high demand commercial locations
- › Suitable for all water systems › 5 year parts and labour guarantee

<b>WIDTH</b>	<b>130 MM</b>
<b>HEIGHT</b>	<b>215 MM</b>
<b>PROJECTION</b>	<b>45 MM</b>

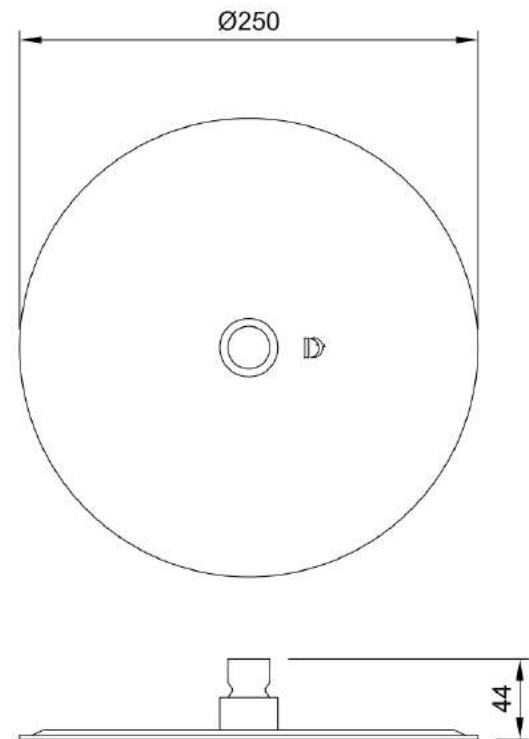

**DB3001**

## DOLPHIN BLUE ROUND SHOWER HEAD

- › Ultra-thin round shower head at 250mm wide with safety valve (Shower Head Only)
- › 2 Flow Regulators included to provide 6 or 9 Litres per minute @ 3 bar
- › 5 Litre per minute flow regulator also available on request
- › 88 Nozzles
- › WRAS Approved
- › Fits DB3060 Ceiling Mounted Arm, DB3061 Wall Mounted Arm and DB3062 Wall Mounted Arm (Supplied separately)
- › Complements most of our other Dolphin taps and fittings
- › Available in polished and satin brushed stainless steel, and can also be powder coated black (RAL9005 15% sheen)
- › High quality brass and stainless steel construction with highest quality cartridges and mechanisms from market leading specialist manufacturers from within Europe to ensure robust and reliable performance in high demand commercial locations
- › Suitable for all water systems
- › 2 year parts and labour guarantee

<b>WIDTH</b>	<b>250MM</b>
<b>HEIGHT</b>	<b>44MM</b>



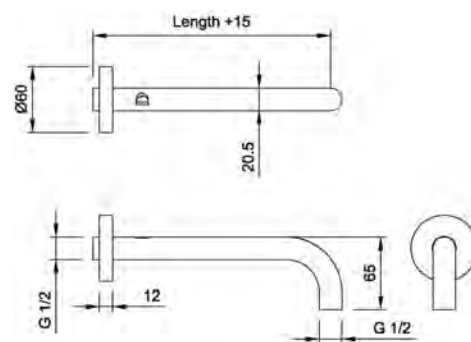

DB3061.xxx.x(.xx)

## DOLPHIN BLUE SHOWER ARM

- › Dolphin Blue Wall Mounted Shower Arm
- › Available in 4 lengths (See Product Codes)
- › WRAS Approved
- › Complements most of our other Dolphin taps and fittings
- › Available in both Satin and Chrome finishes
- › High quality brass construction
- › Suitable for all water systems
- › 2 year parts and labour guarantee

### PRODUCT CODES

- › DB3061.200.x(.xx) 200mm
- › DB3061.250.x(.xx) 250mm
- › DB3061.300.x(.xx) 300mm
- › DB3061.350.x(.xx) 350mm



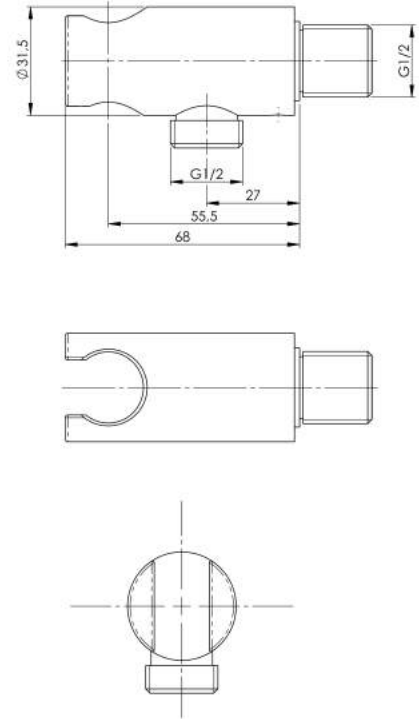

**DB3073**

## DOLPHIN BLUE SHOWER WALL OUTLET & HOLDER

- › Dolphin Blue Wall Outlet and Holder with 1/2" BSP connection
- › Complements most of our other Dolphin taps and fittings
- › Available in both polished and satin/brushed finish Brass in the following colours – PVD in Bronze, Brass, Gold, Rose Gold, Black and Copper and Powder Coated in any RAL colour of your choice
- › High quality brass construction
- › Suitable for all water systems

### PRODUCT CODES

**DB3073.1** - Satin Stainless version

**DB3073.2** - Mirror polish version



**DB3041**

## DOLPHIN SHOWER HOSE

- › 150cm Long flexible stainless steel shower hose - designed to work with our DB3020
- › Prestigious design for high quality shower rooms
- › End nuts constructed from high grade 316 stainless steel, hose from 304 grade stainless steel and internal tube made of EPDM
- › WRAS approved

**LENGTH**

**150CM**

### PRODUCT CODES

**DB3041** - Dolphin shower hose

**DB3020** - Dolphin Hand held shower head

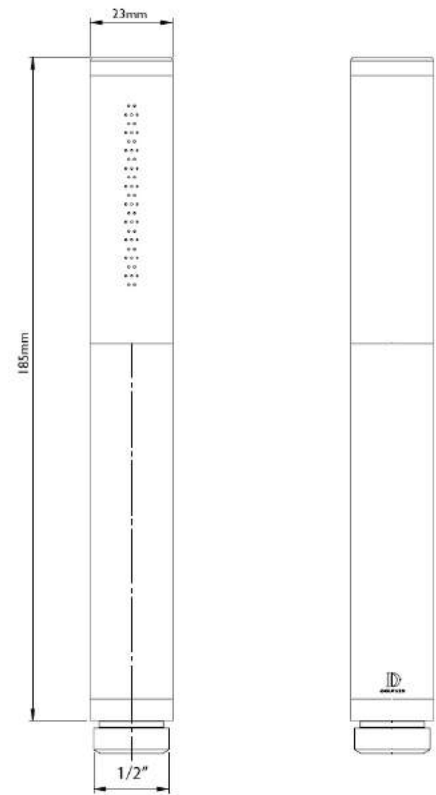

**DB3020**

## DOLPHIN HAND HELD SHOWER HEAD

- > Constructed from high grade stainless steel
- > Available in satin and polished stainless steel finishes
- > To be used with DB3041 shower hose (purchased separately)
- > 1/2" connection
- > Flow regulators for 6 litres per minute and 9 litres per minute included as standard (but not fitted)
- > Also available with flow regulators for 4 Litres per minute (DB58863410000) and 5 litres per minute (DB58863510000)

<b>HEIGHT</b>	<b>185MM</b>
<b>DIAMETER</b>	<b>23MM</b>

### PRODUCT CODES

- DB3020.1** - Satin stainless shower head
- DB3020.2** - Mirror polished shower head
- DB3020.3** - Satin PVD shower head
- DB3020.6** - Ceramic coated shower head
- DB3041** - Dolphin shower hose



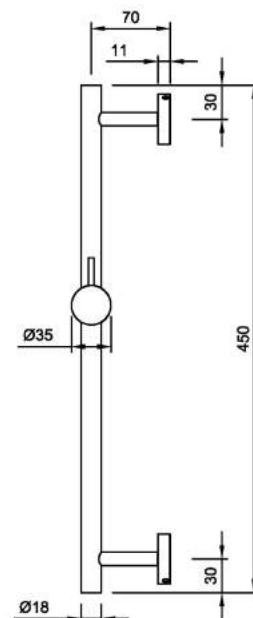
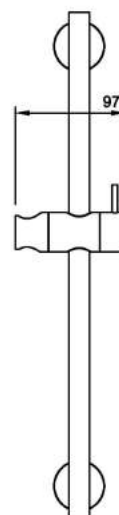
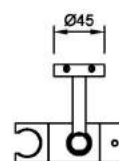

**DB3090.450**

## DOLPHIN BLUE SHOWER SLIDER RAIL AND HOLDER

- › Dolphin Blue Shower Slider Rail and Holder Assembly consisting of two wall mounting brackets with concealed fixings, riser rail and shower head holder
- › Complements most of our other Dolphin taps and fittings
- › Available to be ceramic coated
- › High quality brass construction
- › Suitable for all water systems
- › 2 year parts and labour guarantee

<b>WIDTH</b>	<b>97MM</b>
<b>RAIL DIAMETER</b>	<b>18MM</b>
<b>HEIGHT</b>	<b>450MM</b>
<b>PROJECTION</b>	<b>79MM</b>

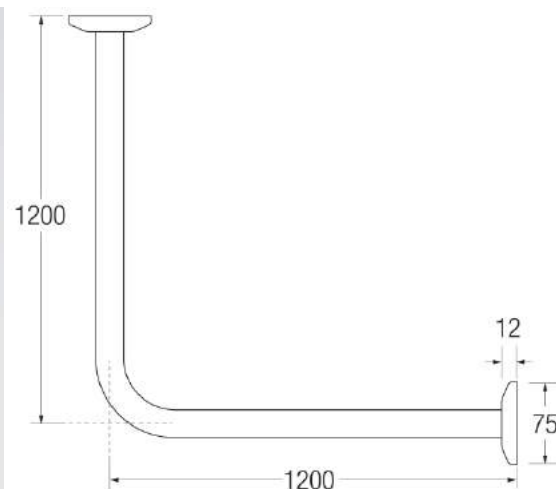
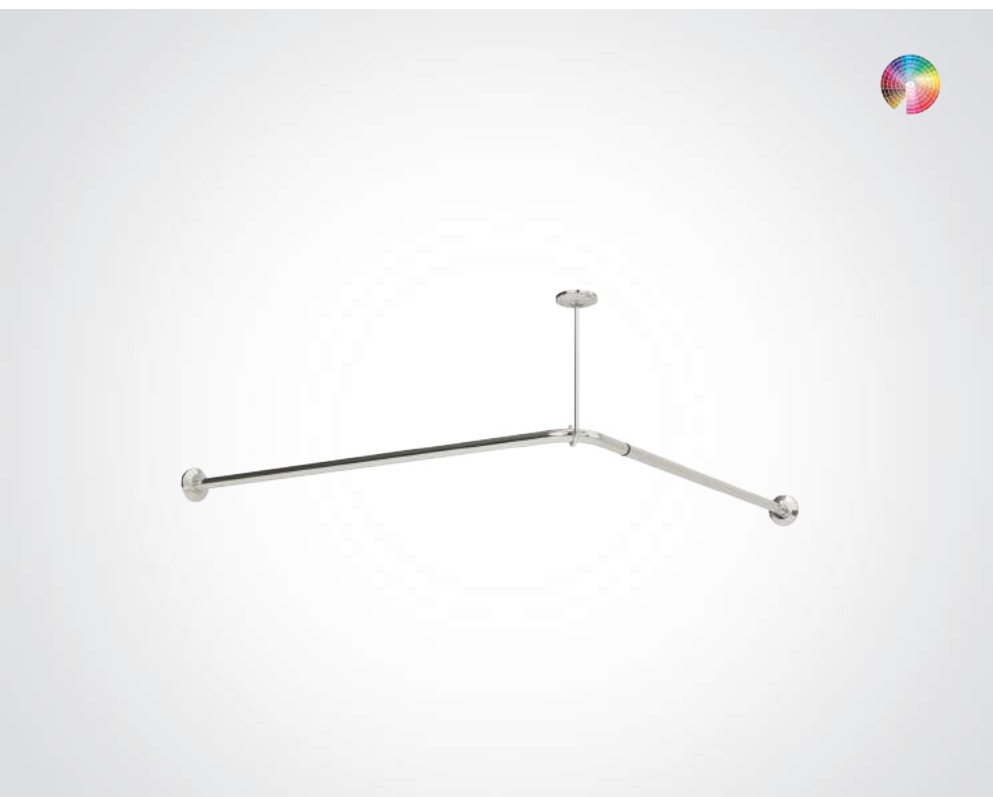

BC5083-11 / BC5083-11-PSS

## DOLPHIN 1200MM X 1200MM SHOWER CURTAIN RAIL

- › Non-corrosive stainless steel construction
- › Concealed fixings
- › Bespoke lengths, shapes and sizes available
- › Doc M compliant
- › Ceiling stay (not included) available for purchase separately, code BC5083-12
- › For use with BC5083-13 curtain hooks and BC5083-14 shower curtain (not included)
- › Available in satin brushed and mirror polish finishes
- › Powder coated finishes in any RAL colour also available

PROJECTION	1200MM
DIAMETER	25MM
HEIGHT FROM CEILING	500MM

### PRODUCT CODES

**BC5083-11** - Stainless Steel Shower Curtain Rail 1200mm x 1200mm Satin Brushed Finish

**BC5083-11-PSS** - Stainless Steel Shower Curtain Rail 1200mm x 1200mm Mirror Polish Finish

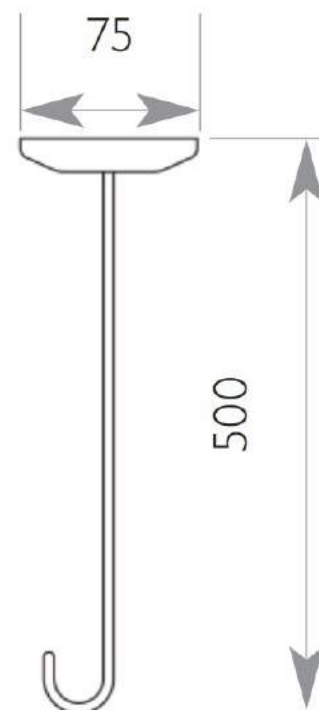

**BC5083-12**

## DOLPHIN SHOWER RAIL CEILING STAY

- › High quality satin stainless steel construction
- › Use with BC5083-13 curtain hooks, BC5083-14 shower curtain, and BC5083-11 curtain rail (all supplied separately)

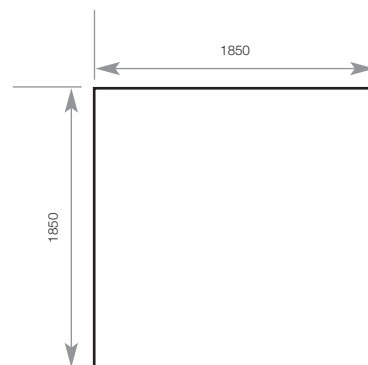

BC5083-14

## DOLPHIN SHOWER CURTAIN

- › White shower curtain
- › 4oz weighted white polyester
- › Hooks are not included with curtain
- › 12 hooks required per curtain

HEIGHT	1830 MM
WIDTH	1830 MM



BC5083-13

## DOLPHIN CURTAIN HOOKS BRASS CHROME PLATED

› Use with BC5083-11 Dolphin corner shower rail

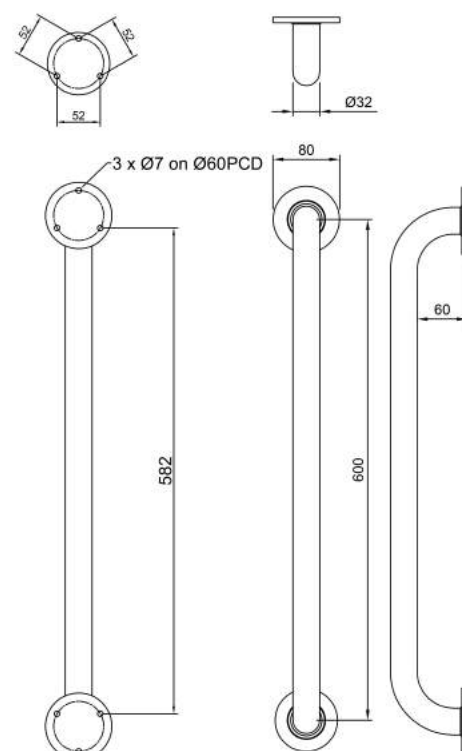

**BC5083-02**

## DOLPHIN STAINLESS STEEL GRAB RAIL

- > High quality satin stainless steel
- > 32mm diameter
- > Concealed fixings
- > The BC5083-02 grab rail has been tested for a load bearing capacity in excess of 200kg in accordance with BS EN 12182:2012 section 16.2

<b>LENGTH</b>	<b>600MM</b>
<b>PROJECTION</b>	<b>92MM</b>
<b>INSIDE PROJECTION</b>	<b>60MM</b>
<b>DIAMETER</b>	<b>32MM</b>

### PRODUCT CODES

**BC5083-01** - Dolphin 450mm grab rail

**BC5083-02** - Dolphin 600mm grab rail

**BC5083-04** - Dolphin 900mm grab rail

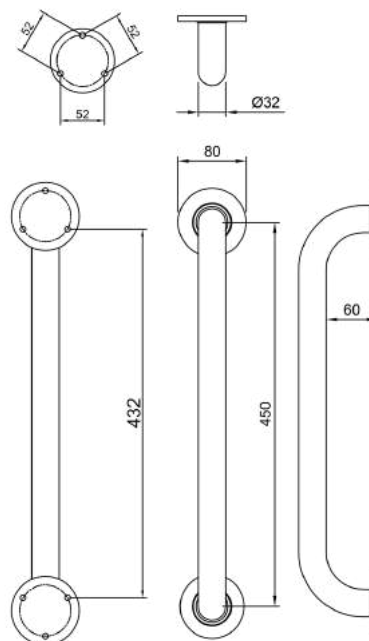

**BC5083-01**

## DOLPHIN 450MM STAINLESS STEEL GRAB RAIL

- > High quality satin stainless steel
- > 32mm diameter
- > Concealed fixings
- > The BC5083-01 grab rail has been tested for a load bearing capacity in excess of 200kg\* in accordance with BS EN 12182:2012 section 16.2

LENGTH	450MM
PROJECTION	92MM
INSIDE PROJECTION	60MM
DIAMETER	32MM

### PRODUCT CODES

- BC5083-01** - Dolphin 450mm grab rail
- BC5083-02** - Dolphin 600mm grab rail
- BC5083-04** - Dolphin 900mm grab rail

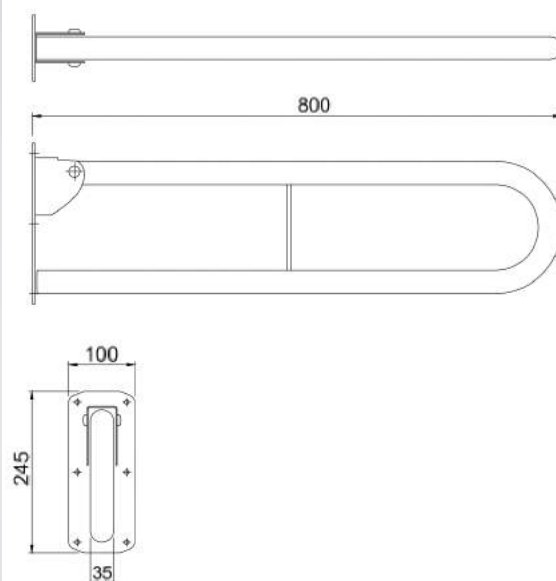

**BC5084-06**

## DOLPHIN STAINLESS STEEL HINGED RAIL

- › Non-corrosive stainless steel construction
- › Soft fall friction mechanism
- › Bespoke lengths, shapes and sizes available
- › Doc M compliant
- › All rails capable of supporting 170kg
- › Also available in a 650mm length (BC5084-06650)

<b>HEIGHT</b>	<b>245MM</b>
<b>DIAMETER</b>	<b>35MM</b>
<b>PROJECTION</b>	<b>800MM</b>
<b>FIXINGS HOLES</b>	<b>8MM</b>



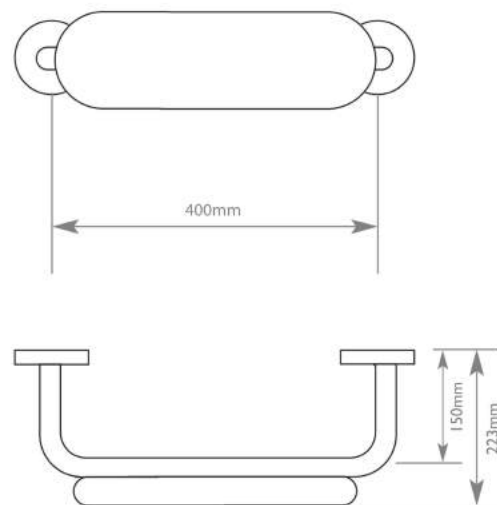

BC5083-37

## DOLPHIN STAINLESS STEEL PADDED BACKREST

- › High quality satin stainless steel and vinyl cushion
- › Concealed fixings
- › Hard wearing and easy to clean vinyl cushion can be supplied in both blue and white vinyl
- › Works well with the BC5083-10 Fold down shower seat
- › Available to be powder coated in any RAL colour (please contact the team for further details)

**PROJECTION**  
**WIDTH**

**223MM**  
**400MM**

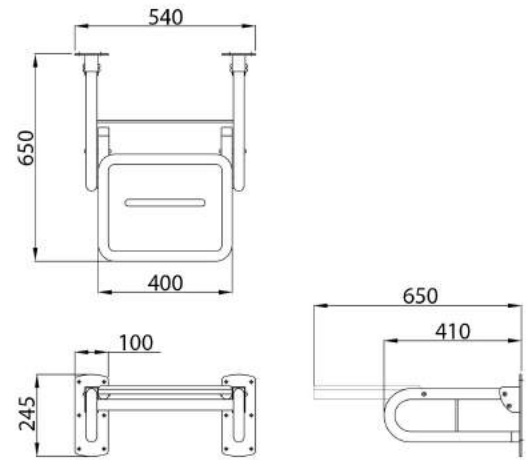

**BC5083-10**

## DOLPHIN DOC M SHOWER SEAT

- › Can be paired with 150mm projection back rest rail and back rest pads to create a back rest for extra comfort.
- › Seat can be flipped up when not in use
- › Available with black or white seats
- › Available in satin or mirror polish finish
- › Doc M compliant
- › Capable of supporting 150kg

<b>WIDTH</b>	<b>540MM</b>
<b>HEIGHT</b>	<b>250MM</b>
<b>PROJECTION</b>	<b>650MM</b>

### PRODUCT CODES

**BC5083-10** - Stainless Steel Doc M Shower Seat With White Seat 650mm Satin Finish

**BC5083-10-PSS** - Stainless Steel Doc M Shower Seat With White Seat 650mm Mirror Polish Finish

**BC5083-10BL** - Stainless Steel Doc M Shower Seat With Black Seat 650mm Satin Finish

**BC5083-10BL-PSS** - Stainless Steel Doc M Shower Seat With Black Seat 650mm Mirror Polish Finish



**BC5083-121**

## STAINLESS STEEL DISABLED ALARM SYSTEM WITH PULL CORD

- › Essential for every public accessible washroom
- › Included in all Dolphin Doc M shower and WC room sets
- › Available in white plastic or satin stainless steel
- › Doc M compliant

### PRODUCT CODES

**BC5083-120** - White Plastic Disabled Alarm System With Pull Cord

**BC5083-121** - Stainless Steel Disabled Alarm System With Pull Cord

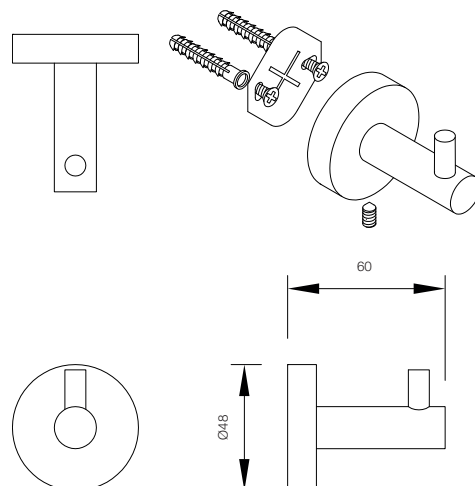
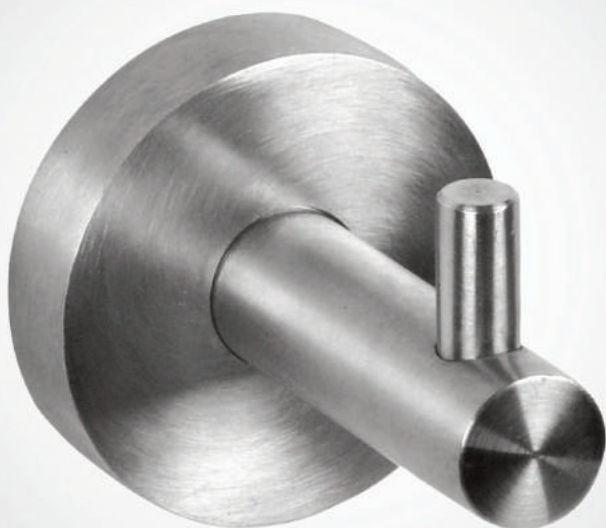

**BC725**

## DOLPHIN SINGLE ROBE HOOK

- › Timeless design for prestigious appearance in high class environments
- › 304 stainless steel for easy care and durability
- › Robust 'hidden fix' anti-rotation wall plate fixing for secure anti-theft mounting
- › Available in satin (brushed) stainless steel to compliment other Dolphin products

<b>DIAMETER</b>	<b>48 MM</b>
<b>PROJECTION</b>	<b>60 MM</b>

### PRODUCT CODES

- › Double hook see

**BC726**

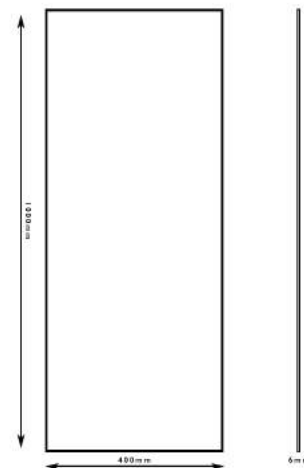
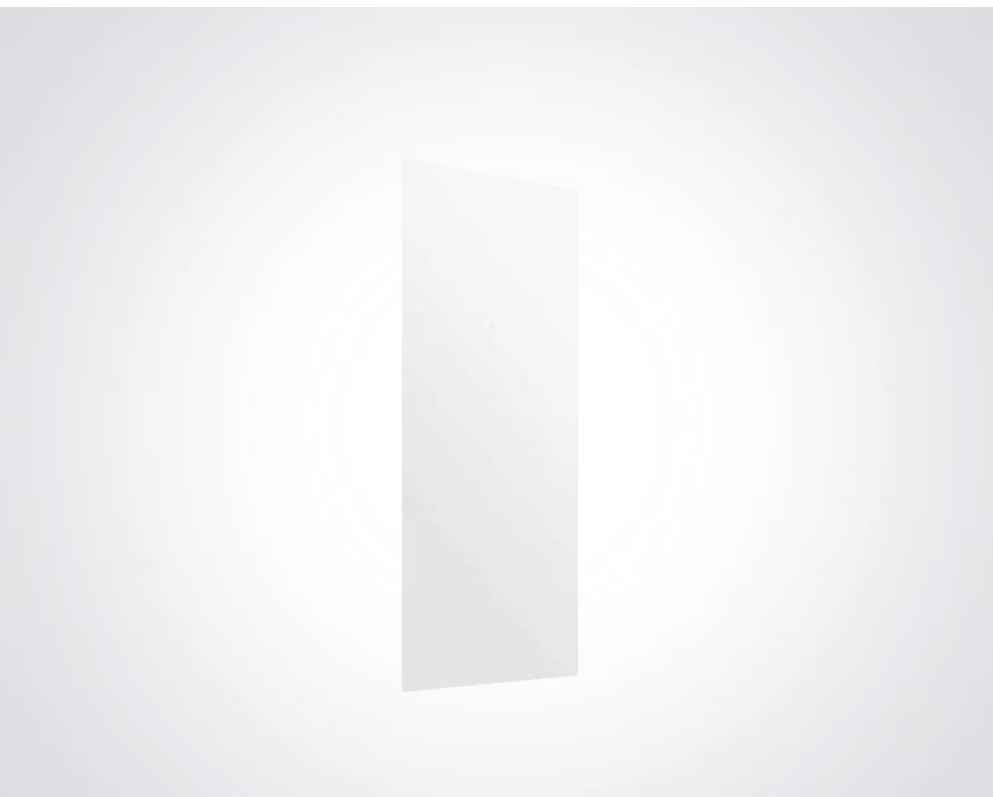

**BC5083-101**

## DOLPHIN SAFETY BACKED MIRROR

- › Safety backed glass mirror
- › Suitable for accessible washrooms and shower rooms
- › 1000mm x 400mm x 6mm
- › Frameless
- › Bespoke options available

<b>HEIGHT</b>	<b>1000MM</b>
<b>WIDTH</b>	<b>400MM</b>
<b>THICKNESS</b>	<b>6MM</b>