

# DOLPHIN SOLUTIONS LIMITED

## DOLPHIN COUNTER MOUNTED SOAP DISPENSER

### DP1207

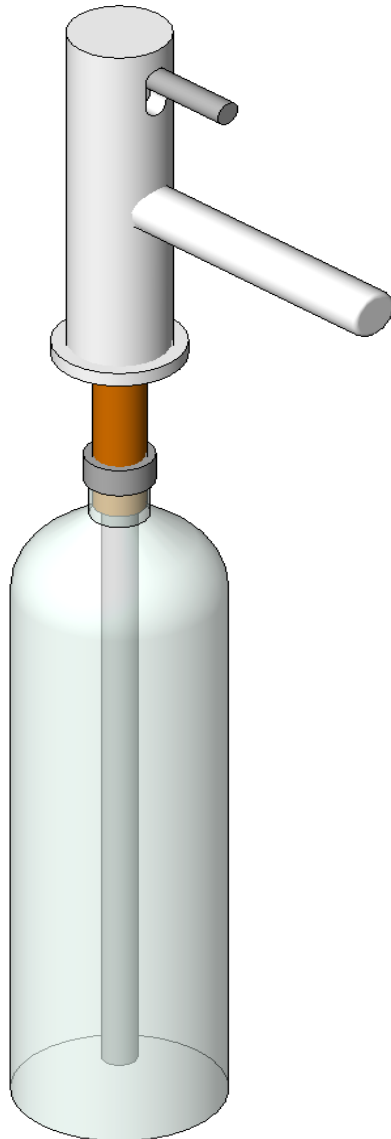

Family Types

Name: DP1207 Dolphin Counter Mounted Soap Dispenser

Parameter	Value
<b>Materials and Finishes</b>	
Material	Easy-care 316 stainless steel
Finish	Satin or Polished stainless steel
<b>Dimensions</b>	
Width	Ø30mm
Projection	85mm
Height	125mm
Counter Thickness	22-30mm
<b>General</b>	
Product Page Link	<a href="https://www.dolphinsolutions.co.uk/en/product/counter-mounted-soap-">https://www.dolphinsolutions.co.uk/en/product/counter-mounted-soap-</a>
Product Data	Superior quality and timeless design for prestigious washrooms. Easy-care 31
Capacity Soap	500ml = 400 shots of soap
<b>Identity Data</b>	
URL	<a href="http://www.dolphinsolutions.co.uk">www.dolphinsolutions.co.uk</a>
Type Comments	
Tel No.	+44 (0) 1424 202 224
Model	DP1207
Manufacturer	Dolphin Solutions Ltd.
Fax No.	+44 (0) 1424 205 200
Email	<a href="mailto:info@dolphinsolutions.co.uk">info@dolphinsolutions.co.uk</a>
Description	Counter mounted soap dispenser
Assembly Code	D2010900
Address	Southpoint, Compass Park, Junction Road, Bodiam, TN32 5BS
Keynote	
Cost	

Family Types: New..., Rename..., Delete

Parameters: Add..., Modify..., Remove

Lookup Tables: Manage...

OK Cancel Apply Help