

# BELL-CHEM PRODUCTS COMPANY DOLPHIN PRESTIGE PANEL MOUNTED SOAP DISPENSER DP 1206

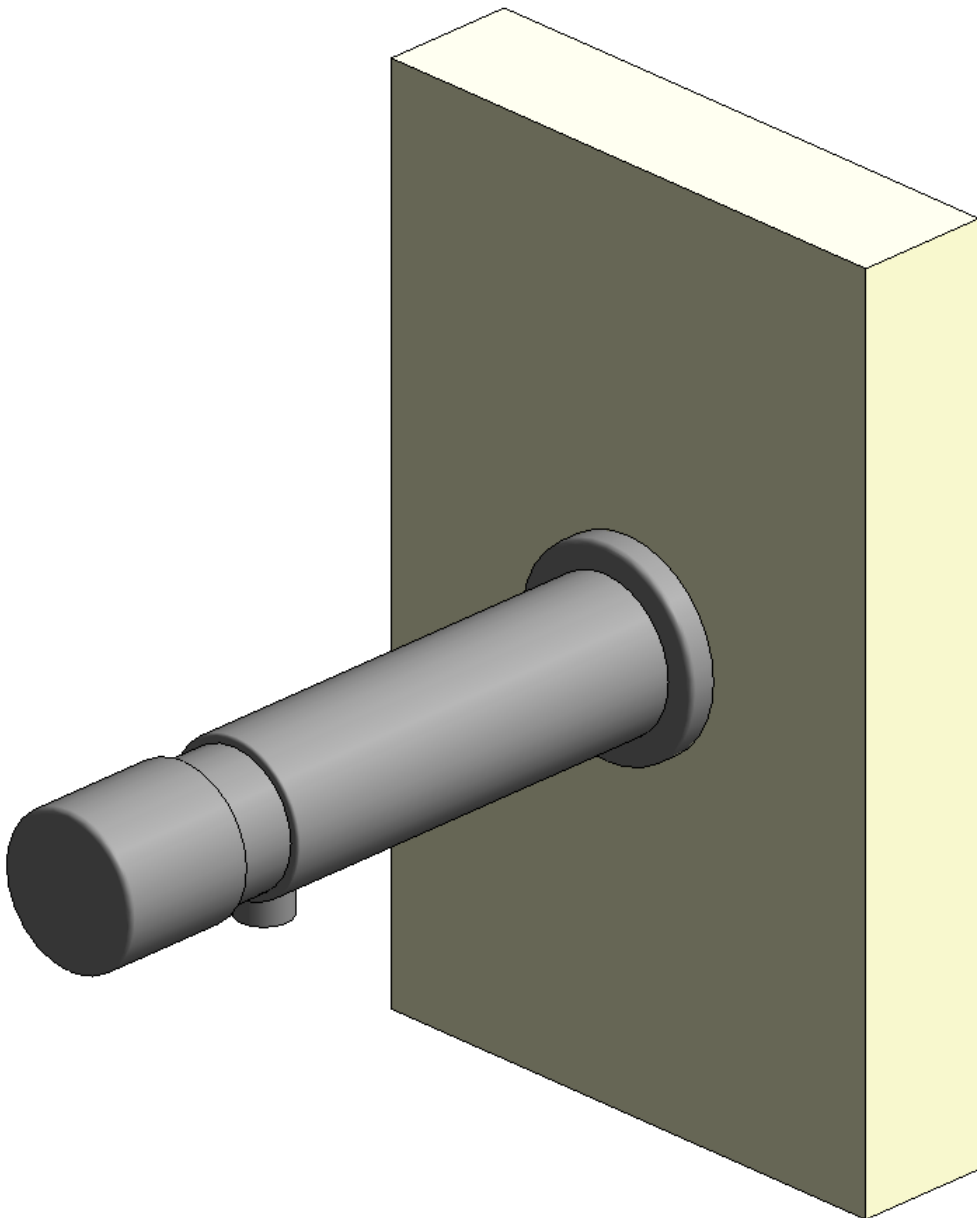

Family Types

Name: DP 1206 Dolphin Prestige Panel Mounted Soap Dispenser

Parameter	Value	
<b>Dimensions</b>		
Width	28mm Dia	=
Projection	124mm	=
Height	38mm Dia	=
Capacity Soap	1,000ml	=
<b>General</b>		
Product Page Link	<a href="http://www.dolphindispensers.co.uk/products/dp1206-dolphin-prestige-panel-mounted-soap-dispenser/31.h">http://www.dolphindispensers.co.uk/products/dp1206-dolphin-prestige-panel-mounted-soap-dispenser/31.h</a>	=
Product Data	80mm to spout, Can be installed in panels up to 40mm thick, Hole diameter through panel 22mm	=
NBS Spec	<a href="http://services.ribea.com/nbsproductdata/NBSPlusProduct.aspx?manufacturer=DolphinDispensers&amp;name=So">http://services.ribea.com/nbsproductdata/NBSPlusProduct.aspx?manufacturer=DolphinDispensers&amp;name=So</a>	=
<b>Identity Data</b>		
URL	<a href="http://www.dolphindispensers.co.uk">www.dolphindispensers.co.uk</a>	=
Type Comments	Formerly Code WP 194	=
Tel No.	+44 (0) 1424 202224	=
Model	DP 1206	=
Manufacturer	Bell-Chem Products Co.	=
Fax No.	+44 (0) 1424 205200	=
Email	<a href="mailto:info@dolphindispensers.co.uk">info@dolphindispensers.co.uk</a>	=
Description	Prestige Panel Mounted Soap Dispenser	=
Assembly Code	D2010900	=
Address line 1	Southpoint, Compass Park, Bodiam, Robertsbridge, TN32 5BS	=
Keynote		=
Cost		=

Family Types: New..., Rename..., Delete

Parameters: Add..., Modify..., Remove

Lookup Tables: Manage...

OK Cancel Apply Help