

BC633 Counter Mounted Soap Dispenser – Sensor Replacement Instructions

TOOLS REQUIRED:

2mm Allen key
2.5mm Allen key
Internal Circlip pliers
Large slotted screwdriver



STEP 1:

Remove fixing nut, washers and rosette.



STEP 2:

Remove 2mm hex grub screw from brass tail.



STEP 3:

Rotate brass tail a quarter turn anti-clockwise

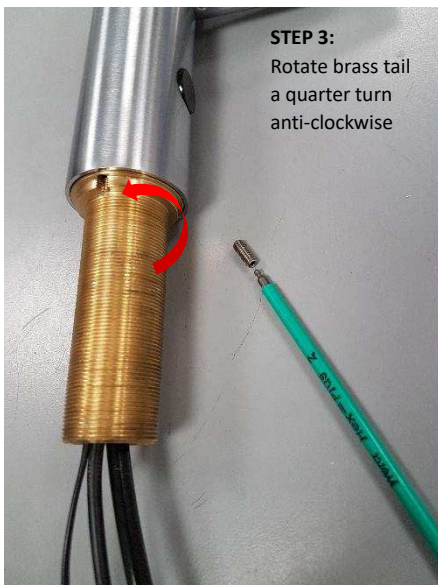

STEP 4:

Remove brass tail



STEP 5:

Remove soap tube by pulling firmly off the brass barb fitting.



STEP 6:

Unscrew (anti-clockwise) brass soap tube fitting with 2.5mm Allen key.

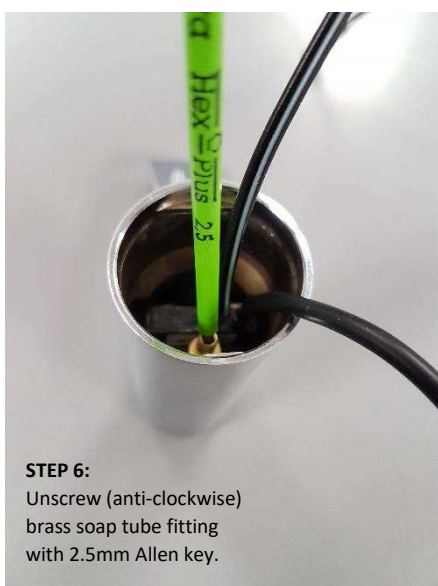

STEP 7:

Remove brass soap tube fitting.



STEP 8:

Push sensor 'eye' to release the sensor module and remove.



STEP 9: Fit replacement sensor in reverse order.