

BABY CHANGE

INSTALLATION INSTRUCTIONS



NAPPY CHANGING UNIT INSTALLATION

Stainless Steel Units

STEEL UNITS

Each stainless steel unit can either be surface-mounted or recessed. A matching stainless steel cover frame is available for surface-mounted installations.

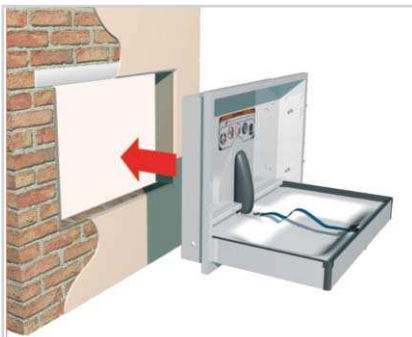

RECESSED FIXING IN MASONRY

Each unit has six recess mounting holes. Form the opening in the brick or blockwork wall, incorporating an appropriate lintel to span the opening. Install rough timber fixing grounds and screw fix the changing unit to the reveals of the opening using minimum 5mm screws. Before final tightening, insert packing shims as necessary for alignment and to obviate any distortion on tightening. Use either flat head screws with finishing washers and flat washers or pan head wood screws with flat washers, making sure that consideration is given to the operating clearance and that the back flange of the unit neatly masks the opening and the termination of the wall finish.



RECESSED FIXING IN STUDWORK

Timber double stud blocking is necessary around the opening. After locating the unit within the framed opening, insert packing shims as necessary for alignment and snug fitting. Secure the unit to the blocking using minimum 5mm flat head wood screws with finishing washers and flat washers or pan head wood screws with flat washers, making sure, as with all fixing methods, that consideration is given to the operating clearance.



SURFACE MOUNTING

The unit can be fixed directly through the back plate using screws and appropriate wall plugs and plastic caps to cover the screw heads. A matching stainless steel cover frame is available for surface-mounted installations which engages the changing unit with a snap fit. The cover frame covers the otherwise exposed edges and provides a neat finishing surround.

RECOMMENDED MOUNTING HEIGHT TO BASE OF UNIT:

Standard – 900mm
Wheelchair – 750mm

- In all mountings, the flat fender washer must be inserted underneath the finishing washer: installing the unit using only the finishing washer may result in the washer biting directly into the body of the unit with consequent damage and loss of stability.
- Nappy changing units are no stronger than the anchors or substrates to which they are attached and as such must be firmly secured in order to support the loads for which they are intended.

NAPPY CHANGING UNIT INSTALLATION

Polyethylene Units

POLYETHYLENE UNITS

Each unit has four mounting ports based on a traditional 400mm stud spacing. Two additional ports are provided for optional use. All fixings are supplied with each unit to cater for fixing to either solid masonry or studded wall constructions.



RECOMMENDED MOUNTING HEIGHTS:

Standard – 900mm
Wheelchair – 750mm

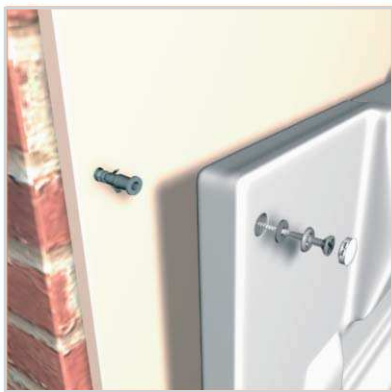

FIXING TO MASONRY

Secure the unit to brick and concrete block substrates using four 5mm x min.75 mm wood screws into proprietary wall plugs. The flat fender washer is to be inserted underneath the finishing washer. Finally, insert the snap-fit plastic covers in each fixing port to cover the fixings.

Fixing to studwork

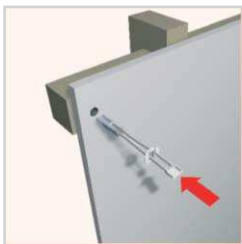

1 Mark out and drill fixing holes. Insert toggle.

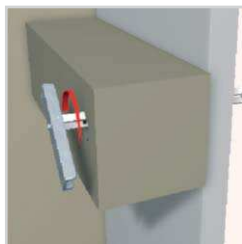

2 Twist toggle freely to gain purchase on the supporting member. There should be a minimum cavity clearance of 65mm to allow the toggle bar to turn.



3 Push the integral disc along the toggle to make a snug purchase on the wall face. The toggle strands are ratched to hold the disc in place.



4 Cut off the surplus projection of the toggle and offer up the unit for fixing.



5 Align and engage the fixing bolt in the threaded toggle bar with washers engaged. The flat fender washer is to be inserted underneath the finishing washer. Finally, insert the snap-fit plastic covers in each fixing port.



ALTERNATIVE FIXING METHOD TO STUDWORK

The BC 100-EH/BC 100-EV unit can be fitted with the EZ Mount backer plate to provide an alternative method of fixing to studded walls.

Two galvanised steel mounting bars are supplied, one pre-fixed to the rear of the unit and the other loose for fixing to the wall. The wall bar has a multitude of fixing holes to cater for variable stud positions.

Dolphin Solutions Ltd
Southpoint, Compass Park,
Junction Road
Bodiam, TN32 5BS,
United Kingdom
T +44 (0)1424 202 224
info@dolphinsolutions.co.uk
dolphinsolutions.co.uk

© Dolphin Solutions Ltd

